

TH400 (3L80)

RWD 3 Speed

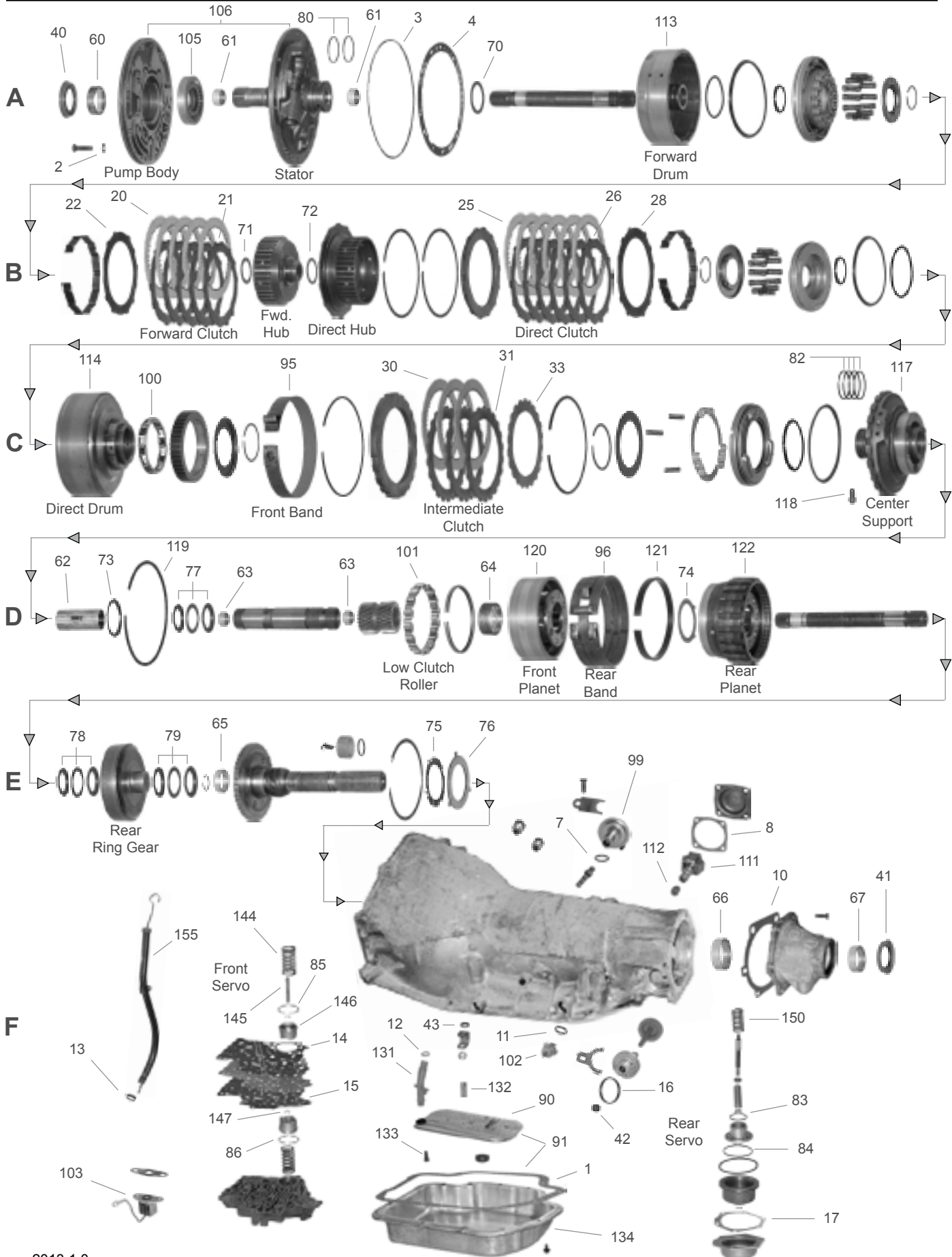

TH400-425-375 (M40), 3L80

ILL. NO.	PART NUMBER	PER CAR	DESCRIPTION	YEARS
	TM400		Technical Manual	1964-92
REBUILDER BOX KITS				
---	MRK3400B-S		Master Rebuilder Kit (w/o Steels) TH400	1968-92
---	K3400B-S		Master Kit (w/o Steels) TH400	1965-92
---	K3400F-S		Master Kit (w/o Steels) TH425	1966-78
Steel Plate Sub-Kits:				
---	K3400B-9		Steel Plate Kit TH400	1965-92
---	K3400F-9		Steel Plate Kit TH425	1966-78
OVERHAUL KITS, GASKET SETS, AND SEAL KITS				
---	K34900A		Overhaul Kit TH400	1965-92
---	K34900F		Overhaul Kit TH425	1966-78
---	K34900A-1		Gasket and Rubber Kit (TH400) Duraprene	1965-92
---	K34900A-1X		Gasket and Rubber Kit (TH400) Cork/Rubber	1965-92
---	K34900F-1		Gasket and Rubber Kit (TH425) Duraprene	1966-78
---	K34900-7		Front Pump Seal-Up Kit	1964-92
---	K34900-8		External Seal-Up Kit TH400	1964-92
---	K34900B-3		Valve Body Gasket Kit Combo	1965-92
GASKET AND RUBBER COMPONENTS				
1F	34170	1	Pan Gasket (TH400) Duraprene	1964-92
1F	34170X	1	Pan Gasket (TH400) Cork/Rubber	1964-92
---	34170F	1	Pan Gasket (TH425) Duraprene	1966-78
2A	3601SL	8	Front Pump Bolt Washer Seal	1964-92
3A	3877L	1	Front Pump Body Lathe Cut Seal Except TH425	1964-92
4A	3994L	1	Front Pump Cover to Case Gasket	1964-92
7E	3410L	1	Modulator to Case O'Ring	1964-92
8E	3914L	1	Governor Cover Gasket Duraprene	1964-92
10E	3922SL	1	Extension Housing to Case Gasket	1964-92
11F	66118	1	Case Connector O'Ring	1964
11F	3410L	1	Case Connector O'Ring	1965-92
12F	3248L	1	Filter to Case O'Ring	1964-92
13F	3291L	1	Oil Filler Tube O'Ring	1964-78
13F	44141	1	Oil Filler Tube Lip Seal Lip Type	1979-92
14F	3993L	1	Spacer Plate to Case Gasket Yellow Stripe	1965-86
14F	34103	1	Spacer Plate to Case Gasket	1987-92
15F	34102	1	Spacer Plate to Valve Body Gasket	1965-92
---	3267	1	Output Shaft O'Ring	1964-92
16F	3347L	1	Speedometer Adapter O'Ring	1964-92
---	3718L	1-2	Speedometer Sleeve O'Ring TH425	1966-78
---	3991L	1	Speedometer Driven Gear Lip Seal (w/o Spring)	1964-92
---	3991LX	1	Speedometer Driven Gear Lip Seal (w/Spring)	1964-92
17F	3916L	1	Rear Servo Cover Gasket Metal	1964-92
---	44140	1	Linkage Grommet	1964-92

TH400

TH400-425-375 (M40), 3L80 - Cont'd.

ILL. NO.	PART NUMBER	PER CAR	DESCRIPTION	YEARS
CLUTCH PLATES				
20B	34304	5	Forward Clutch Friction (Smooth)080"	1964-92
20B	34304A	5	Forward Clutch Friction (Grooved)080"	1964-92
20B	34304B	5	Forward Clutch H.D. Friction (Waffle)080"	1964-92
20B	33304E	AR	Forward Clutch Friction (High Energy)080"	1964-92
21B	34305	5	Forward Clutch Steel (Waved)068"	1964-66
21B	34305A	3-4	Forward Clutch Steel (Flat)077"	1965-92
21B	34305C	4-5	Forward Clutch Steel (Flat)092"	1966-92
22B	34305B	1-2	Forward Clutch Steel (Waved)060"	1965-92
22B	34305D	1	Forward Clutch Steel (Dished)054"	1966-92
25B	34304	5-6	Direct Clutch Friction (Smooth)080"	1964-92
25B	34304A	5-6	Direct Clutch Friction (Grooved)080"	1964-92
25B	34304B	5-6	Direct Clutch H.D. Friction (Waffle)080"	1964-92
25B	33304E	AR	Direct Clutch Friction (High Energy)080"	1964-92
26B	34305	5	Direct Clutch Steel (Waved)068"	1964-66
26B	34305C	2-6	Direct Clutch Steel (Flat)092"	1966-92
28B	34305B	1	Direct Clutch Steel (Waved)060"	1967-92
28B	34305D	1	Direct Clutch Steel (Dished)054"	1966-92
30C	34404	3	Intermediate Clutch Friction (Smooth - Waved)080"	1964-92
30C	33306E	AR	Intermediate Clutch Friction (High Energy - Flat) .. .070"	1964-92
31C	34405	2-3	Intermediate Clutch Steel (Flat)100"	1964-92
31C	33307	AR	Intermediate Clutch Steel (Flat)076"	1964-92
33C	34405A	1	Intermediate Clutch Steel (Waved)068"	1965-92
METAL CLAD SEALS				
40A	44526	1	Front Pump	1964-92
41E	34743A	1	Extension Housing w/2.750" O.D.	1965-92
41E	37551	1	Extension Housing w/2.505" O.D.	1964-70
41E	45551	1	Extension Housing (w/Flange) w/2.380" O.D.	1973-92
41E	34743M	1	Extension Housing (Motor Home) w/2.885" O.D.	1971-92
42F	3991LX	1	Speedometer Pinion (Rubber w/Spring)	1965-92
43F	44507	1	Manual Control Shaft	1964-92
BUSHINGS				
---	K34980	1	Bushing Kit (* Not Included) TH400	1964-92
60A	8005	1	Front Pump Body	1964-92
61A	34002	2	Stator Support (Front & Rear)	1964-92
62D	34003	1	Center Support	1964-92
63D	34002	2	Sun Gear Shaft	1964-92
64D	34007	1	Reaction Carrier	1964-92
65E	34004A	1	Output Shaft Support423" Wide	1964-92
66E	34006	1	Case	1964-92
66E	33007Y*	1	Case "No-Walk"	1964-92
67E	34005A	1	Extension Housing 2.00" O.D. x 1.50" Long	1965-92
67E	34005B*	1	Extension Housing 2.00" O.D. x 1.00" Long	1965-92
67E	8008*	1	Extension Housing (Babbitt) 1.63" O.D. x .093" Long	1973-77
67E	45008*	1	Extension Housing (Bronze) 1.63" O.D. x .093" Long	1973-77
67E	45008T*	1	Extension Housing (Teflon) 1.63" O.D. x .093" Long	1973-77
---	34921*	1	Governor Bore Repair Sleeve	1964-92

TH400-425-375 (M40), 3L80 - Cont'd.

TH400

ILL. NO.	PART NUMBER	PER CAR	DESCRIPTION	YEARS
THRUST WASHERS AND BEARINGS				
---	K34940	1	Thrust Washer Kit (w/o Selectives)	1964-92
---	K34940A	1	Forward Clutch to Pump Selective Washer Kit	1964-92
---	K34941	1	Thrust Bearing Kit	1964-92
---	K34442	1	End-Play Shim Kit (Front or Rear, (10) .010" Shims)	1964-92
70A	34208A	AR	Pump to Forward Drum073"	1964-92
70A	34208B	AR	Pump to Forward Drum084"	1964-92
70A	34208C	AR	Pump to Forward Drum095"	1964-92
70A	34208D	AR	Pump to Forward Drum106"	1964-92
70A	34208E	AR	Pump to Forward Drum117"	1964-92
70A	34208F	AR	Pump to Forward Drum128"	1964-92
71B	34302A	1	Forward Clutch Hub (Front)	1964-92
72B	34301	1	Forward Clutch Hub (Rear) Bronze, .063"	1964-92
72B	34301B	1	Forward Clutch Hub (Rear) Plastic, .063"	1964-92
72B	K34301C	1	Forward Clutch Hub (Rear) Bronze, .078" (5-Pieces)	1964-92
72B	K34301D	1	Forward Clutch Hub (Rear) Bronze, .094" (5-Pieces)	1964-92
73D	34401	1	Center Support to Reaction Carrier Bronze	1964-92
74D	34501	1	Reaction Carrier to Output Carrier (Metal) 4-Tab	1964-92
74D	45412	1	Reaction Carrier to Output Carrier (Plastic) 4-Tab	1964-92
75E	34501	1	Output Shaft to Case 4-Tab	1964-92
76E	34409A	AR	Output Shaft to Case076"	1964-92
76E	34409B	AR	Output Shaft to Case084"	1964-92
76E	34409C	AR	Output Shaft to Case092"	1964-92
76E	34409D	AR	Output Shaft to Case100"	1964-92
76E	34409E	AR	Output Shaft to Case108"	1964-92
76E	34409F	AR	Output Shaft to Case116"	1964-92
---	K34050¹	1	Case Saver Kit	1964-92
¹ Use when output shaft selective washer has spun in case, includes ill. # 66F, 75E & 76E.				
77D	K34907	1	Center Support to Sun Gear Needle Bearing Kit	1964-92
78E	33423F	1	Rear Internal Gear Needle Bearing Kit Front (Late Design)	1964-92
79E	K34906	1	Rear Internal Gear Needle Bearing Kit Rear	1964-92
SEALING RINGS				
---	K34901A	1	Sealing Ring Kit TH400	1965-92
---	K34901B	1	Sealing Ring Kit TH425	1966-78
80A	34406	2	Front Pump Cover Cast Iron	1964-92
---	34120	2	Input Shaft to Support TH425/VP400	1966-78
82C	34406	4	Center Support Cast Iron	1964-92
83F	34710AT	1	Rear Servo Accumulator Piston Inner - Teflon	1965-92
84F	34710C	1	Rear Servo Accumulator Piston Outer - Metal	1971-92
84F	33208T	1	Rear Servo Accumulator Piston Outer - Teflon	1971-92
85F	34711	1	Front Servo Piston Cast Iron	1964-92
86F	34711	1	Front Servo Accumulator Piston Cast Iron	1964-92
TRANSMISSION OIL FILTERS				
90F	34800	1	Oil Filter w/Pickup Tube	1964-67
90F	34801	1	Oil Filter Dacron Type	1968-92
90F	34801T	1	Oil Filter Mesh Type	1968-92
90F	34802	1	Oil Filter TH425	1966-78
91F	ATK-1	1	Oil Filter Kit w/Pickup Tube	1964-67
91F	ATK-9	1	Oil Filter Kit w/Dacron Filter	1968-92
91F	ATK-11	1	Oil Filter Kit TH425	1966-78
---	45605	1	Governor Pressure Screen See Page 1.33-10 for Visual Identification	1964-92

TH400-425-375 (M40), 3L80 - Cont'd.

ILL. NO.	PART NUMBER	PER CAR	DESCRIPTION	YEARS
BANDS				
95C	34325	1	Front	1964-92
95C	34325HE	AR	Front (High Energy) Must Use with 33732E, 2.730" Long Servo Pin	1964-92
96D	34510	1	Rear	1964-92
VACUUM MODULATORS				
99E	34820R	1	Dual Red Stripe Adjustable 1-11/16" Diaphragm	1966-92
99E	44820X	1	Black/Red Stripe Adjustable 2" Diaphragm	1969-92
SPRAGS AND ROLLER CLUTCHES				
100C	34418	1	Intermediate Sprag Assembly 16 Elements	1964-92
100C	34418HD	1	Intermediate Sprag Assembly 34 Elements	1964-92
100C	34418A	1	Intermediate Roller Assembly	1964-92
101D	34402A	1	Low Clutch Roller Assembly	1966-92
SHIFT ENHACEMENTS AND VALVES				
---	K34944	1	Valve Body Shift Kit TransGo	1964-92
---	ST34944	1	Shift Correction Package Superior	1964-92
---	K34946	1	Harsh Reverse Correction Kit TH400	1964-92
---	400-1 & 2	1	Tow-or-Go/Competition Kit TH400	1965-92
---	400-3	1	Stick Shift Re-Programming Kit TH400	1965-92
---	400-PRO	1	Pro-Race Re-Programming Kit TH400	1965-92
---	K34889LB	1	Line Pressure Booster Kit (Sonnax)	1965-92
---	K34889 ²	1	Reverse Boost Valve and Sleeve ² Addresses poor line rise and shift complaints.	1964-92
---	K34989G	1	Pressure Regulator Valve Kit	1971-92
ELECTRICAL COMPONENTS				
102F	34932	1	Connector Switch 1-Prong	1968-92
102F	34933	1	Connector Switch 2-Prong	1970-82
103F	34925	1	Detent Solenoid Short Wire	1964-92
MISCELLANEOUS AND HARD PARTS				
Note : When ordering Hard Parts, please add the appropriate suffix : (-R) Reman, (-U) Used, (-A) Aftermarket.				
Pumps and Components:				
105A	K44965	1	Front Pump Gear Package721"	1964-92
105A	K44967	1	Front Pump Gear Package723"	1964-92
105A	K44966	1	Front Pump Gear Package725"	1964-92
105A	K34965	1	Front Pump Gear Package727"	1964-92
105A	K34965A	1	Front Pump Gear Package727" & Oversized .030"	1964-92
106A	K34895B	1	Front Pump Assembly 8-Bolt	1971-92
106A	K34895C	1	Front Pump Assembly 6-Bolt	1971-92
Governor:				
111E	34420	1	Governor Assembly	1964-92
112E	K34914	1	Governor Gear & Pin Kit TH400	1964-92
---	34914F	1	Governor Gear & Pin Kit - FWD TH425	1966-78

TH400-425-375 (M40), 3L80 - Cont'd.

TH400

ILL. NO.	PART NUMBER	PER CAR	DESCRIPTION	YEARS
MISCELLANEOUS AND HARD PARTS - Cont'd.				
Note : When ordering Hard Parts, please add the appropriate suffix : (-R) Reman, (-U) Used, (-A) Aftermarket.				
113A	34805	1	Forward Drum	1964-92
114C	34803	1	Direct Drum (Sprag Type)	1964-72
114C	34803B	1	Direct Drum (Roller Type)	1971-92
117C	34808B	1	Center Support (Roller Type)	1966-92
---	GM-1027	1	Case Saver (For Center Support Area)	1964-92
---	K34808CS	1	Case Saver (For Center Support Area)	1964-92
118C	34892	1	Case to Center Support Bolt	1964-92
119D	34250	1	Center Support Spacer	1964-92
120D	34833	1	Reaction Carrier (Front Planetary, 4-Pinion, Helical - Sprag Type)	1964-92
120D	34833B	1	Reaction Carrier (Front Planetary, 4-Pinion, Helical - Roller Type - Can Use 33833)	1964-92
120D	33833H	1	Reaction Carrier (Front Planetary, 5-Pinion, Helical)	1964-92
121D	34834	1	Reaction Carrier Ring (Silencer) Plastic	1964-92
122D	34831	1	Output Carrier (Rear Planetary, 4-Pinion, Helical)	1964-92
122D	33831H	1	Output Carrier (Rear Planetary, 5-Pinion, Helical)	1964-92
131F	34881	1	Filter Intake Pipe (Use w/Shallow Pan)	1968-92
131F	34881T	1	Filter Intake Pipe (Use w/Deep Pan)	1968-92
132F	34882	1	Valve Body to Filter Spacer (Use w/Deep Pan)	1964-92
133F	34883	1	Valve Body to Filter Bolt (Use w/Deep Pan)	1964-92
134F	34884	1	Transmission Oil Pan (Deep Type)	1964-92
134F	K34884	1	Transmission Oil Pan (Aftermarket Deep Type)	1964-92
144F	53771HD	1	Front Servo Retracting Spring No Color	1964-92
145F	33732E	1	Servo Apply Pin (2.730" Long, Use with 34325HE Band to Retrofit)	1964-92
146F	34782	1	Front Accumulator Piston Metal	1964-92
147F	44793	1	Front Accumulator Piston E-Clip	1964-92
---	K34742R	1	Front Accumulator Pins and Reamer Kit (Ten Oversized Pins, Sonnax)	1964-92
---	K34742	1	Front Accumulator Pins (Four Oversized Pins, Sonnax)	1964-92
150F	34771B	1	Rear Accumulator Spring (Softer) Blue	1964-92
150F	34771Y	1	Rear Accumulator Spring (Firmer) Yellow	1964-92
---	45934	1	Parking Pawl Shaft Expansion Plug	1964-92
---	44140	1	Linkage Grommet	1964-92
---	K34050	1	Case Saver Kit (Use when 34409 has spun in case, Includes ill. # 66E, 75E & 76E)	1964-92
---	34921	1	Governor Bore Repair Sleeve	1964-92
155F	FT350U	1	Universal Filler Tube and Dipstick Assembly	1964-92
---	NT115A	1	Filler Tube Repair End (w/Boot)	1964-92
---	34840	1	Case Vent Tube	1964-92
TOOLS				
---	B18	1	18" Case Bushing Driver Handle (Ideal for case bushing installation)	1964-92
---	T33	1	Front Pump Remover	1964-92
---	T124	1	Lip Seal Installer Protector Kit	1964-92
---	T134	1	Front Pump Seal Installer	1964-92
---	T1001	1	Shift Lever Seal Remover/Installer	1964-92
---	T1097	1	Front Pump Alignment Tool	1964-92
---	T222	1	Front Pump Alignment Tool (Universal)	1964-92
---	K34912	1	Governor Bore Repair Tool and Bushing Driver	1964-92