

TH125 / 125C (3T40)

FWD 3 Speed

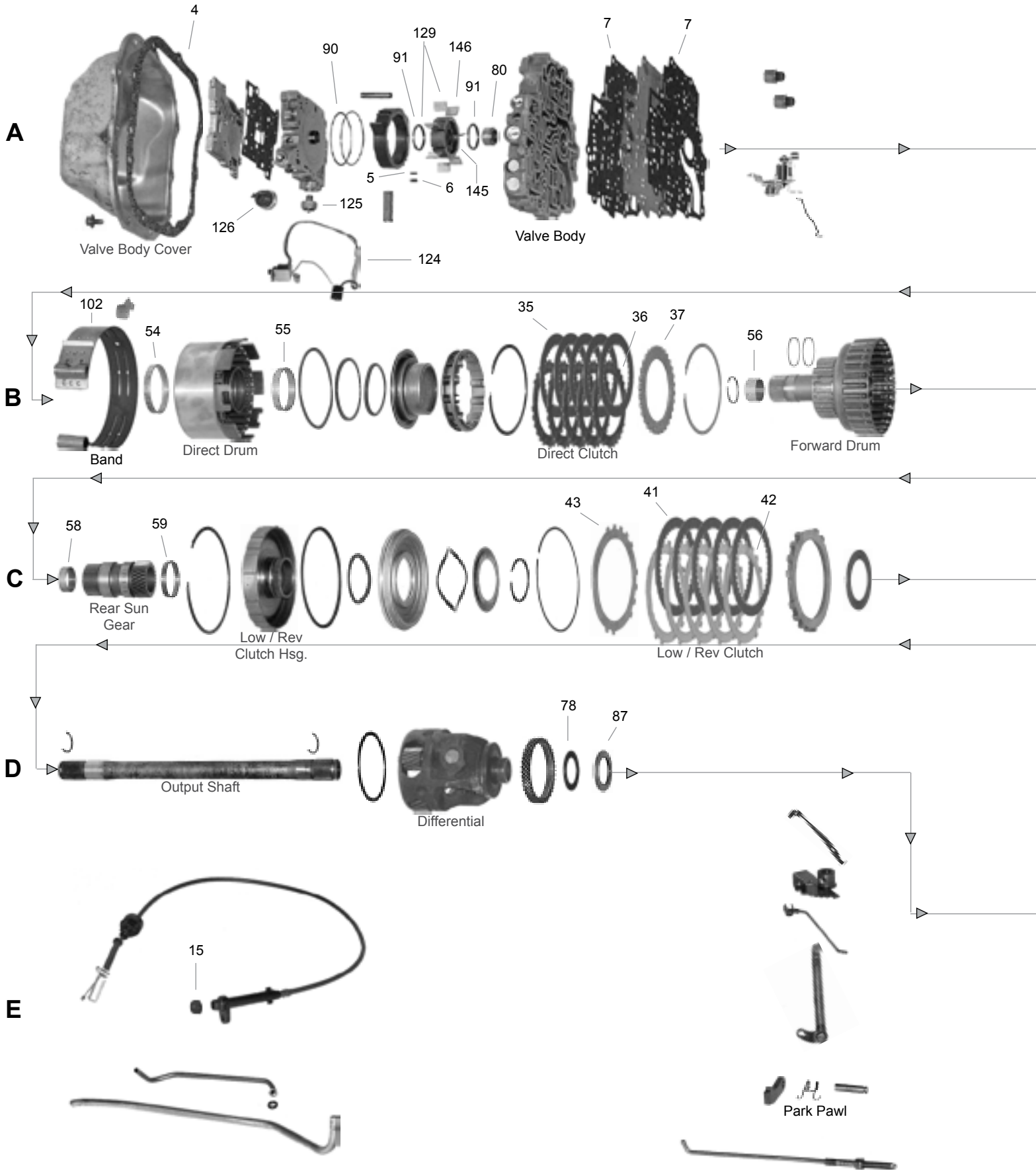

TH125 (M34) 125C (MD9) 3T40

ILL. NO.	PART NUMBER	PER CAR	DESCRIPTION	YEARS
	TM125C		Technical Manual.....	1980-00
REBUILDER BOX KITS				
---	MRK4600-S		Master Rebuilder Kit (w/o Steels).....	1980-84
---	MRK4600B-S ¹		Master Rebuilder Kit (w/o Steels).....	1985-93
---	MRK4600F-S ¹		Master Rebuilder Kit (w/o Steels)..... w/High Energy Band	1994-00
---	K4600-S		Master Kit (w/o Steels)	1980-84
---	K4600B-S ¹		Master Kit (w/o Steels)	1985-00
Steel Plate Sub-Kits:				
---	K4600-9		Steel Plate Kit.....	1980-84
---	K4600B-9 ^{1,2}		Steel Plate Kit.....	1985-00
¹ Some 1988-00 units may utilize (5) Direct frictions and steels, please order an additional 46304B friction and 46305 steel separately if needed. ² Some 1987-00 units may require (1) additional waved Forward steel 46305B and (2) Low & Reverse waved steels 46322C , please order separately as needed.				
OVERHAUL KITS, GASKET SETS AND SEAL KITS				
---	K46900C		Overhaul Kit	1980-00
---	K46900B-1		Gasket and Rubber Kit..... Duraprene	1985-00
---	K46900-3		Valve Body Gasket Kit	1980-00
---	K52900-5		Speedometer Sensor Seal Kit..... Electronic	1989-00
GASKET AND RUBBER COMPONENTS				
3E	46170	1	Pan Gasket..... Duraprene	1980-00
4A	46175	1	Valve Body Cover Gasket	1980-00
---	3601SL	6	Front Pump Bolt Washer Seal.....	1980-00
5A	46821	1	Pump Slide Seal..... Teflon	1980-00
6A	46824	1	Pump Slide Seal Support	1980-00
7A	46106	2	Valve Body Spacer Gasket.....	1980-00
10A	46130	1	Turbine Shaft O'Ring.....	1982-00
11D	3991L	1	Speedometer Driven Gear Lip Seal (w/o Spring).....	1980-00
11D	3991LX	1	Speedometer Driven Gear Lip Seal (w/Spring).....	1980-00
12D	3718L	1	Speedo Sleeve O'Ring (w/Cruise Control).....	1980-00
12D	3410L	1	Speedo Sleeve O'Ring (w/o Cruise Control).....	1980-00
14E	44141	1	Filler Tube Seal	1980-00
15E	45141	1	Detent Cable Seal	1980-00
---	3410L	1	Electrical Connector O'Ring	1982-00
---	45125	1	Reverse Housing Plug Seal	1980-00
---	46150	1	Pump Drive Shaft Seal Washer.....	1982-84
---	51133	1	Axle Stabilizer O'Ring.....	1980-82
19E	46127	1	Filter to Case Seal..... Lip Type	1980-00
CLUTCH PLATES				
35B	46304	4	Direct Clutch Friction	1980-84
35B	46304B	4-5	Direct Clutch Friction	1985-00
36B	46305	4-5	Direct Clutch Steel.....	1980-00
37B	52317	1	Direct Clutch Pressure Plate	1980-00
38B	46304	4	Forward Clutch Friction	1980-84
38B	46304B	4	Forward Clutch Friction	1985-00
39B	46305A	3-4	Forward Clutch Steel.....	1980-00
40B	46305B	1-2	Forward Clutch Steel (Waved)	1980-00

CLUTCH PLATES - Cont'd.

TH125 (M34) 125C (MD9) 3T40

ILL. NO.	PART NUMBER	PER CAR	DESCRIPTION	YEARS
41C	46321	5	Low & Reverse Friction080"	1980-84
41C	46321B	5	Low & Reverse Friction090"	1985-00
42C	46322	5	Low & Reverse Steel..... .078"	1980-84
42C	46322B	4-5	Low & Reverse Steel..... .087"	1985-00
43C	46322C	1-2	Low & Reverse Steel (Waved)078"	1987-00
METAL CLAD SEALS				
46D	46526	1	Converter.....	1980-00
47D	46507	1	Manual Shaft.....	1980-83
47D	46507A	1	Manual Shaft.....	1984-00
48AD	46551	2	Axle.....	1980-00
48D	46551B	1	Axle Stabilizer Seal Use w/K46995B	1980-00
BUSHINGS				
---	K46980	1	Bushing Kit (w/o Converter Bushing)	1980-00
50D	46005A	1	Converter	1982-00
51A	46921	1	Case Cover Repair Sleeve.....	1980-00
52A	45001	1	Drive Sprocket Support	1980-00
53A	46002	1	Driven Sprocket Support.....	1980-00
54B	46003	1	Direct Clutch Drum Front	1980-00
55B	46004	1	Direct Clutch Drum Rear	1980-00
56B	46010	1	Input Shaft.....	1980-00
57B	46006	1	Input Internal Gear	1980-00
58C	46007	1	Reaction Sun Gear.....	1980-00
59C	46008	1	Low & Reverse Clutch Housing.....	1980-00
60C	46008	1	Reaction Carrier	1980-00
61C	46009	1	Final Drive Internal Gear	1980-00
62D	46009	1	Case.....	1980-00
THRUST WASHERS AND BEARINGS				
---	K46940	1	Thrust Washer Kit (w/o Selectives)	1980-00
---	K46941	1	Thrust Needle Bearing Kit	1980-00
Washers:				
66A	46406	1	Case Cover to Drive Sprocket..... 4-Tab	1980-00
68A	46405	1	Drive Sprocket.....	1980-00
69A	46413A	1	Driven Sprocket to Driven Shaft.....	1980-00
70A	46400	1	Support to Direct Clutch Drum	1980-00
71B	46401A	1	Input Shaft to Input Internal Gear 1.220" I.D.	1980-88
72B	46402	1	Input Carrier to Input Internal Gear	1980-00
73B	46403	1	Input Carrier to Input Sun Gear	1980-00
---	K46426	1	Input Carrier Pinion Washer Kit.....	1980-00
75C	46404	1	Reaction Carrier to Internal Gear Front	1980-00
76C	45410	1	Reaction Carrier to Internal Gear Rear	1980-00
---	K46427	1	Reaction Carrier Pinion Washer Kit.....	1980-00
---	K46421	1	Differential Carrier Pinion Washer Kit..... .440" I.D.	1980-00
---	K46421A	1	Differential Carrier Pinion Washer Kit..... .554" I.D.	1980-00
78D	K46440	AR	Differential Carrier to Case Shim Kit (Ten 010" Shims)	1980-00
78D	46409A	AR	Differential Carrier to Case Washer..... 1.50mm	1980-00
78D	46409E	AR	Differential Carrier to Case Washer..... 2.05mm	1980-00
78D	46409F	AR	Differential Carrier to Case Washer..... 2.15mm	1980-00
79D	46418	1	Speedometer Gear.....	1980-84
79D	53427	1	Speedometer Gear Bearing	1985-00
THRUST WASHERS AND BEARINGS - Cont'd.				

TH125 / C

TH125 (M34) 125C (MD9) 3T40 - Cont'd.

ILL. NO.	PART NUMBER	PER CAR	DESCRIPTION	YEARS
Bearings:				
80A	46415A	1	Pump Shaft Bearing Assembly..... .600" Long	1984-00
81A	52430	1	Drive Sprocket Drawn Cup Bearing (Not in Kit)	1980-00
82A	44211	1	Driven Sprocket Needle Bearing.....	1980-00
84C	45411	1	Reaction Sun to Internal Gear Needle Bearing.....	1980-00
85C	46407	1	Sun Gear to Internal Gear Needle Bearing	1980-00
86C	45411	1	Sun Gear to Carrier Needle Bearing 2.000" O.D.	1980-00
86C	52427	1	Sun Gear to Carrier Needle Bearing 2.125" O.D.	1982-00
87D	46408	1	Differential to Case Needle Bearing	1980-00
79D	53427	1	Speedometer Gear Bearing	1985-00
SEALING RINGS				
---	K46901	1	Sealing Ring Kit..... Teflon	1980-00
90A	46825T	1	Pump Slide to Cover Teflon	1980-00
91A	46822	2	Front Pump Vane (Standard) 1.4151" O.D.	1980-00
95A	46202TS	2	Turbine Shaft (Front) Solid	1980-00
96A	46202T	1	Turbine Shaft (Rear) Scarf Cut	1980-81
96A	46202AT	1	Turbine Shaft (Rear) Solid	1982-00
99D	46203T	1	Governor Teflon	1980-00
100E	46210	1	Intermediate Band Apply Pin..... Teflon	1980-00
BANDS				
102B	46714A	1	Intermediate - 1.74" Wide.....	1980-93
102B	46714F	1	Intermediate - 1.74" Wide (High Energy)	1994-00
TRANSMISSION OIL FILTERS				
104E	46600A	1	Oil Filter	1980-00
105E	ATK-84	1	Oil Filter Kit.....	1980-00
ROLLER CLUTCHES				
110C	46814	1	Low Clutch Roller Assembly	1980-00
CHAINS				
113A	46888	1	Drive Chain..... 3/4" Wide	1980-83
113A	46888L	1	Drive Chain..... 7/8" Wide	1984-00
SPRINGS				
115A	46771	1	1-2 Accumulator	1980-00
122E	46772R	1	Intermediate Servo Cushion..... Red	1982-00
122E	46775	1	Intermediate Servo Cushion..... Purple	1980-00
SHIFT ENHANCEMENT KITS AND VALVES				
---	K46944	1	Valve Body Shift Kit..... TransGo	1980-00
---	K46889A³	1	T.V. and Reverse Boost Valve Kit..... Sonnax	1980-00
³ Improves line pressure rise and shift quality.				
ELECTRONIC COMPONENTS				
124A	52870T	1	Solenoid Assembly (Universal Type - Fitzall)	1982-00
124A	52870U	1	Solenoid Assembly (Universal Type - Rostra)	1982-00

TH125 (M34) 125C (MD9) 3T40 - Cont'd.

ILL. NO.	PART NUMBER	PER CAR	DESCRIPTION	YEARS
124A	46870	1	Solenoid Assembly (All 1982-87 and 1988-On Except Below)	1982-00
124A	46870F	1	Solenoid Assembly (w/2nd Clutch Switch & 3rd 1-Prong Normally Open Switch)	1988-89
124A	46870G	1	Solenoid Assembly (w/2nd Clutch Switch & 3rd 1-Prong Normally Closed Switch)	1989-00
125A	46875	1	3rd Pressure Switch (Normally Closed) 1-Prong	1982-00
125A	45876R	1	3rd Pressure Switch (Normally Open) 2-Prong	1982-00
125A	51876	1	3rd Pressure Switch (Normally Open) 1-Prong	1988-89
126A	46876G	1	2nd Pressure Switch 3-Prong	1989-00
127A	45878	1	Converter Clutch Connector..... 3-Prong	1982-00
127A	51878	1	Converter Clutch Connector..... 4-Prong	1982-00

MISCELLANEOUS AND HARD PARTS

Pump Components:

91A	46822	2	Front Pump Vane Rings (Standard)1.4151" O.D.	1980-00
129A	K46820	1	Front Pump Vane and Ring Kit.....	1980-00
145A	46817A	1	Pump Rotor..... 15-Tooth Spline	1980-00
146A	46823	7	Pump Vane.....	1980-00
149A	46816A	1	Pump Shaft..... 15-Tooth Spline	1982-84
149A	46816B	1	Pump Shaft w/Spacer..... 15-Tooth Spline	1984-00

Other Components:

155A	46782	1	Intermediate Accumulator Piston	1980-00
156A	K46782W	1	Intermediate Accumulator Piston and Pin (Sonnax)	1980-00
---	51935	1	Direct Clutch Check Valve with Retainer.....	1980-00
163E	K46889A	1	3rd Accumulator Check Valve AssemblyOEM Design	1980-00
---	52931	1	Forward Clutch Check Valve with Retainer.....	1980-00
164E	46732	1	Intermediate Band Apply Pin..... No Grooves	1980-00
---	K46995B	1	Right Side Axle Stabilizer Kit Bearing Type	1980-00

TOOLS

---	T1059HD	1	Low/Reverse Clutch Center Support Remover/Installer.....	1980-00
---	T1201	1	Output Shaft C-Ring Remover/Installer.....	1980-00
---	T1263	1	Converter Seal Installer.....	1980-00
---	T1274	1	Turbine Shaft Seal Installer/Resizer Cover Side	1980-00
---	T1274A	1	Turbine Shaft Seal Installer/Resizer Case Side	1980-00

TH125 / C