

4R44E, 4R55E, 5R44E, 5R55E

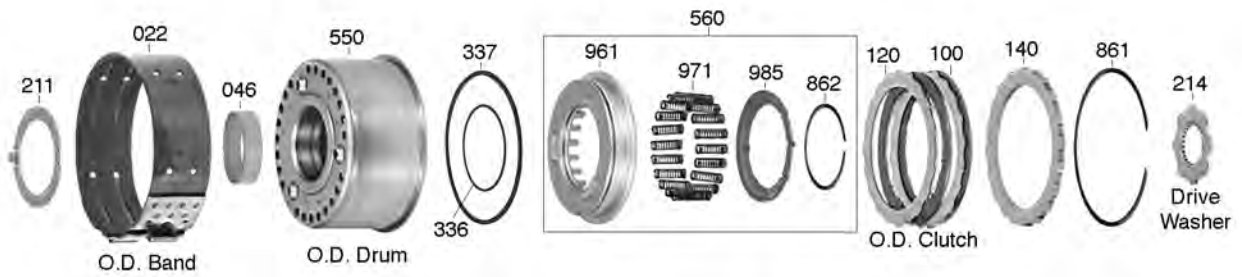

E

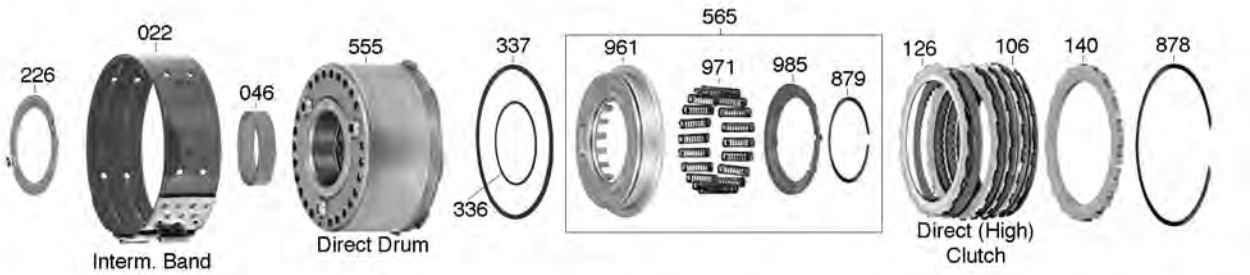

F



G



H



Deluxe Kit	—	008
Compliance Kit	—	007
Master Kit	—	006
Less Steel Kit	—	004
Overhaul Kit	—	002
Bushing Kit	—	030
Washer Kit	—	200
Bearing Kit	—	201
Technical Manual	—	400
Pump Parts	—	507
Valve Body Parts	—	741
Case Parts	—	761

Note: Not All Items Are Available For All Transmissions.

Ford 4R44E/55E, 5R44E/55E

4R44E, 4R55E, 5R44E, 5R55E

Rwd 4/5 Speed

ILL #	Description	Qty	Year	Part #	Reference
Super Kit With Steels (Deluxe)				Fiber	Cork
008H	..(2wd) 4R44E, 4R55E	1	95-96	.56008HAF	..56008HA
008H	..(2wd) 4R44E, 5R44E, 5R55E	1	97-Up	.56008LAF	..56008LA
008H	..(4wd) 4R44E, 4R55E	1	95-96	.56008HBF	..56008HB
008H	..(4wd) 4R44E, 5R44E, 5R55E	1	97-Up	.56008LBF	..56008LB
Super Kit Less Steels (Compliance)				Fiber	Cork
007H	..(2wd) 4R44E, 4R55E	1	95-96	.56007HAF	..56007HA
007H	..(2wd) 4R44E, 5R44E, 5R55E	1	97-Up	.56007LAF	..56007LA
007H	..(4wd) 4R44E, 4R55E	1	95-96	.56007HBF	..56007HB
007H	..(4wd) 4R44E, 5R44E, 5R55E	1	97-Up	.56007LBF	..56007LB
With Steel Kit (Master)				Fiber	Cork
006H	..4R44E, 4R55E	1	95-96	.56006HF	..56006H
006H	..4R44E, 5R44E, 5R55E	1	97-Up	.56006LF	..56006L
Less Steel Kit				Fiber	Cork
004H	..4R44E, 4R55E	1	95-96	.56004HF	..56004H
004H	..4R44E, 5R44E, 5R55E	1	97-Up	.56004LF	..56004L
Overhaul Kit w/ Rings & Seals				Fiber	Cork
002H	..4R44E, 4R55E	1	95-96	.56002HF	..56002H
002H	..4R44E, 5R44E, 5R55E	1	97-Up	.56002LF	..56002L
Gasket & Seal Kit w/o Rings & Seals				Fiber	Cork
000H	..4R44E, 4R55E	1	95-96	.56000HF	..56000H
000H	..4R44E, 5R44E, 5R55E	1	97-Up	.56000LF	..56000L
Filters					
010D	..2wd (Felt) (Metal & Plastic)	1	95-Up	.56010H	..F5TZ-7A098-A
010D	..4wd (Felt) (Metal & Plastic)	1	95-Up	.56010G	..F5TZ-7A098-B
Filter Kits					
011D	..2wd (Felt) (Metal & Plastic)	1	95-Up	.56011H	
011D	..4wd (Felt) (Metal & Plastic)	1	95-Up	.56011G	
Bands					
. Prefix Key: B = Borg Warner, A = OEM (Exc BW), N = All Other New, R = Relined					
022E	..Intermediate & Overdrive	1-2	95-Up	.56022E	..74DT-7B034-AA
022E	..Intermediate & Overdrive (Kevlar)	AR	95-Up	.56022EK	..E6TZ-7D034-A
024D	..Reverse	1	95-Up	.56024	..E3ZZ-7D095-A
Bushings					
030H	..Bushings Kit	1	95-96	.56030D	
034A	..Converter Housing (Babbitt)	1	95-Up	.56034	..D4TP-7A834-AB
034A	..Converter Housing (Bronze)	1	95-Up	.56034B	..D4TP-7A834-AB
034A	..Converter Housing (Sure-Seal) (Teckpak)	1	95-Up	.T56034	..56001SS
034A	..Converter Housing (Unfinished) (Sonnax)	1	95-Up	.S56034	..56001X
036A	..Stator (Front) (w/ Grooves on ID & OD) (.750" Long)	1	95-Up	.56036B	
036A	..Stator (Front) (w/ Grooves on ID & OD) (Aftermarket 1" Long)	1	95-Up	.56036BA	
037A	..Stator (Rear)	1	95-Up	.56037	
046E	..Direct/Reverse (Cast Iron) Drum	1	95-96	.56046	
046E	..Direct/Reverse (Steel) Drum	2	95-96	.56046B	..90DT-7D046A
052G	..Sun Gear	2	95-Up	.56052	..74DT-7D065-AA
061D	..Reverse Drum	1	95-Up	.56061	
062H	..Bearing, Output Shaft Pilot	1	95-Up	.56268	
064D	..Case (Bushings)	1	95-96	.56064	..D7FZ-7A034-A
263H	..Case (Bearing (Cage Type)	1	97-Up	.56263B	..F77Z-7R205-AA
066H	..Extension Housing (Babbitt)	1	95-Up	.56066	..D7FZ-7A034-A
066H	..Extension Housing (Bronze)	1	95-Up	.56066B	

Ford 4R44E/55E, 5R44E/55E

ILL #	Description	Qty	Year	Part #	Reference
Metal Clad Seals					
070A	.Front (Deep Lip)	.1	.95-96	.56070A	.E5TZ-7A248-A
070A	.Front (No Flange) (Rubber Coated)	.1	.97-Up	.56070B	.F7ZZ-7A248-AA
072D	.Linkage	.1	.95-Up	.36072	.D5AZ-7B498-A
074H	.Rear (w/o Boot)	.1	.95-Up	.56074	.D5ZZ-7052-A
074H	.Rear (w/ Boot)	.1	.95-Up	.56074B	.E2ZZ-7052-A
Friction Plates					
100E	.Overdrive .069" (16 T)	.3	.95-96	.56100A	.90GT-7B164-BA
100E	.Overdrive .069" (16 T) (w/ Directional Grooves)	.3	.97-Up	.56100B	.F7ZZ-7B164-CA
106F	.Direct .069" (48 T)	.6	.95-96	.56106A	.90DT-7B164-BA
106F	.Direct .069" (48 T) (w/ Directional Grooves)	.6	.97-Up	.56106B	.F7ZZ-7B164-BA
108C	.Forward .069" (72 T)	.6	.95-96	.56108A	.90DT-7B164-AA
108C	.Forward .069" (72 T) (w/ Directional Grooves)	.6	.97-Up	.56108B	.F7ZZ-7B164-AA
Steel Plates					
120E	.Overdrive .065" (20 T)	.3	.95-Up	.56120B	.FOTZ-7B442-B
126F	.Direct .065" (20 T)	.6	.95-Up	.56120B	.FOTZ-7B442-B
126F	.Direct .082" (20 T)	.6	.97-Up	.56120C	.F7ZZ-7B442-AA
128C	.Forward .065" (19 T)	.6	.95-Up	.56128C	.FOTZ-7B442-A
139	.Steel Module	.1	.95-96	.56139G	
139	.Steel Module	.1	.97-Up	.56139H	
Pressure Plates					
.Prefix Key: D = Dealer, No Prefix = New Aftermarket, Q = Quality Inspected					
140E	.Direct & Overdrive .200" (20T)	.2	.95-Up	.56140B	.FOTZ-7B066-B
148C	.Forward .200" (19T)	.1	.95-Up	.56148D	.FOTZ-7B066-A
Valve Body Recalibration Kits					
165H	.Shift Kit®, 4R44E, 4R55E, 5R44E, 5R55E (Transgo)	.1	.95-01	.T56165H	.SK® 44-55E
165H	.Shift Correction Package, 4R44E, 4R55E, 5R44E, 5R55E (Superior)	.1	.95-Up	.S56165H	.K4R/5R55E
165H	.Valve Body Kit (Sonnax EZ)	.1	.95-Up	.A56165H	.37947-EZ
Sealing Rings					
175H	.Ring Kit	.1	.95-96	.56175E	
175H	.Ring Kit	.1	.97-Up	.56175L	
178A	.Front Stator (Scarf cut)	.1	.95-96	.56178T	.E5TZ-7L323-A
178A	.Front Stator (Solid)	.1	.97-Up	.56178L	.97GT-7L323-AA
179A	.Over Drive & Direct Drum (Teflon)	.2-4	.95-96	.56179T	.E5TZ-7D025-A
179A	.Over Drive & Direct Drum (Green Plastic)	.1	.97-Up	.56179L	
181C	.Forward (Metal)	.2	.95-96	.56181	.D4ZZ-7D019-A
181C	.Forward (Bronze)	.1	.97-Up	.56181L	
Thrust Washers					
200H	.Washer Kit	.1	.95-96	.56200EA	
210K	.Shim Kit, Pump & Center Support Washers	.1	.95-96	.56210K	
211E	.Pump & Center Support .055" Metal	.1	.95-96	.56211B	.FOTZ-7D014-A
211E	.Pump & Center Support .055" Plastic (Pump has a Caged Bearing)	.1	.97-Up	.56211BA	.F7TZ-7D014-VA
211E	.Pump & Center Support .063" Metal	.1	.95-96	.56211C	.FOTZ-7D014-B
211E	.Pump & Center Support .063" Plastic (Pump has a Caged Bearing)	.1	.97-Up	.56211CA	.F7TZ-7D014-TA
211E	.Pump & Center Support .067" Metal	.1	.95-96	.56211D	.FOTZ-7D014-C
211E	.Pump & Center Support .071" Metal	.1	.95-96	.56211E	.FOTZ-7D014-D
211E	.Pump & Center Support .071" Plastic (Pump has a Caged Bearing)	.1	.97-Up	.56211EA	.F7TZ-7D014-MA
211E	.Pump & Center Support .075" Metal	.1	.95-96	.56211G	.FOTZ-7D014-E
211E	.Pump & Center Support .075" Plastic (Pump has a Caged Bearing)	.1	.97-Up	.56211GA	.F7TZ-7D014-NA
211E	.Pump & Center Support .079" Metal	.1	.95-96	.56211H	.FOTZ-7D014-F
211E	.Pump & Center Support .079" Plastic (Pump has a Caged Bearing)	.1	.97-Up	.56211HA	.F7TZ-7D014-PA
211E	.Pump & Center Support .083" Metal	.1	.95-96	.56211J	.FOTZ-7D014-G
211E	.Pump & Center Support .083" Plastic (Pump has a Caged Bearing)	.1	.97-Up	.56211JA	.F7TZ-7D014-RA
211E	.Pump & Center Support .087" Metal	.1	.95-96	.56211K	.FOTZ-7D014-H
211E	.Pump & Center Support .087" Plastic (Pump has a Caged Bearing)	.1	.97-Up	.56211KA	.F7TZ-7D014-SA
211E	.Pump & Center Support .094" Metal	.1	.95-96	.56211L	.FOTZ-7D014-J

Ford 4R44E/55E, 5R44E/55E

4R44E, 4R55E, 5R44E, 5R55E

Rwd 4/5 Speed

ILL #	Description	Qty	Year	Part #	Reference
Thrust Washers					
211E	. . . Pump & Center Support .094" Plastic (Pump has a Caged Bearing)	.1	.97-Up	.56211LA	
211E	. . . Pump & Center Support .102" Metal	.1	.95-96	.56211M	. . . F0TZ-7D014-K
211E	. . . Pump & Center Support .110" Metal	.1	.95-96	.56211N	. . . F0TZ-7D014-L
211E	. . . Pump & Center Support .110" Plastic (Pump has a Caged Bearing)	.1	.97-Up	.56211NA	
214E	. . . Overdrive Sun Gear Drive (Star Washer)	.1	.95-Up	.56214	. . . E5TZ-7660-A
229C	. . . Direct Drum to Forward Drum (Washer) (Metal)	.1	.95-Up	.56229	. . . E5TZ-7C096-A
229C	. . . Direct Drum to Forward Drum (Bearing)	.1	.97-Up	.56229B	. . . F7ZZ-7M153-EB
232C	. . . Washer, Bearing to Planet (.350") Bronze	.1	.95-Up	.56232C	. . . F0TZ-7D090-A
232C	. . . Bearing w/ Race, Forward Drum to Planet (Used w/ 56232C)	.1	.95-Up	.56232D	. . . F3TZ-7D234-A
243G	. . . Sun Shell to Rear Planet Washer	.1	.95-Up	.56243	. . . D4ZZ-7D066-A
244G	. . . Rear Planet to Hub (3" OD) (6 Outer Tab)	.1	.95-96	.56244B	. . . F0TZ-7A166-B
244G	. . . Sun Shell to Rear Planet (3 Outer Tabs)	.1	.95-96	.56244A	. . . F0TZ-7A166-A
244G	. . . Sun Shell to Rear Planet	.1	.97-Up	.56244C	. . . F7ZZ-7M151-BA
254D	. . . Between Rear Hub & Sprag Race 3 3/16" OD (Bronze)	.1	.95-Up	.56254B	. . . F0TZ-7D422-A
257D	. . . Rear Case Thrust (4.0L) (OE Style)	.1	.95-Up	.56257	
257D	. . . Rear Case Thrust (4.0L) (Aftermarket Style)	.1	.95-Up	.56257C	
257D	. . . Washer Kit, Low Sprag End Cap & Washer (4R55E) (Sonnax)	.1	.95-96	.S56257K56250-01K
263D	. . . Output Shaft Park Gear to Case (Large OD)	.1	.95-96	.56263	. . . D4ZZ-7B368-A
263D	. . . Output Shaft Park Gear to Case (Small OD)	.1	.97-Up	.56263A	. . . F77Z-7B368-AA
Bearings & Races					
211E	. . . Bearing, Pump & Center Support .110"	.1	.97-Up	.56211NB	. . . XW4Z-7D014-CA
211E	. . . Bearing, Pump & Center Support .116"	.1	.97-Up	.56211PB	. . . XW4Z-7D014-DA
211E	. . . Bearing, Pump & Center Support .124"	.1	.97-Up	.56211RB	
211E	. . . Bearing, Pump & Center Support .132"	.1	.97-Up	.56211SB	
216B	. . . Race, Overdrive Planet to Overdrive Sun Gear (Front)	.1	.95-96	.56216	. . . E5TZ-7D235-B
217B	. . . Bearing, Between Overdrive Planet & Overdrive Ring Gear Hub	.1	.95-Up	.56217	. . . E5TZ-7L495-A
229C	. . . Washer, Direct Drum to Forward Drum (Metal)	.1	.95-Up	.56229	. . . E5TZ-7C096-A
229C	. . . Bearing, Direct Drum to Forward Drum	.1	.97-Up	.56229B	. . . F7ZZ-7M153-EB
223B	. . . Bearing, Center Support Front (.105")	.1	.95-96	.56223A	. . . F3TZ-7L326-A
223B	. . . Bearing, Center Support Front (.115") (1 Notch)	.1	.95-96	.56223AA	. . . F5TZ-7L326-A
223B	. . . Bearing, Center Support Front (.122") (2 Notch)	.1	.95-96	.56223AB	. . . F5TZ-7L326-B
223B	. . . Bearing, Center Support Front (.129") (3 Notch)	.1	.95-96	.56223AC	. . . F5TZ-7L326-C
223B	. . . Bearing, Center Support	.1	.97-Up	.56229B	. . . F7ZZ-7M153-EB
226F	. . . Bearing, Center Support to Forward Drum (.157")	.1	.95-96	.56226	. . . F3TZ-7C096-A
226F	. . . Bearing, Center Support to Forward Drum (.149") (1 Notch)	.1	.95-96	.56226A	. . . F3TZ-7C096-B
226F	. . . Bearing, Center Support to Forward Drum (.143") (2 Notch)	.1	.95-96	.56226AA	. . . F3TZ-7C096-C
226F	. . . Bearing, Center Support to Forward Drum (.135") (3 Notch)	.1	.95-96	.56226AB	. . . F3TZ-7C096-D
226F	. . . Bearing, Center Support	.1	.97-Up	.56229B	. . . F7ZZ-7M153-EB
232C	. . . Bearing, Forward Drum to Planet (Used w/ 56232C)	.1	.95-Up	.56232D	. . . F3TZ-7D234-A
235G	. . . Bearing, Between Forward Planet & Hub	.1	.95-Up	.56235A	. . . F2TZ-7F374-AA
244G	. . . Bearing, Sun Shell to Rear Planet	.1	.95-Up	.56244C	. . . F7ZZ-7M151-BA
251G	. . . Bearing, Rear Planet to Hub	.1	.95-Up	.56229B	. . . F7ZZ-7M153-EB
254D	. . . Bearing, Rear Ring Gear Hub to Case	.1	.97-Up	.56254G	
254D	. . . Bearing & Race Kit, Rear Ring Gear Hub to Case	.1	.97-Up	.56254GK	
255D	. . . Race, Rear Ring Gear Hub to Case	.1	.97-Up	.56255G	
263H	. . . Bearing, Case (Cage Type) (95-96 uses bushing # 56064)	.1	.97-Up	.56263B	. . . F77Z-7R205-AA
268	. . . Bearing, Output Shaft Pilot	.1	.95-Up	.56268	
Gaskets & O-Rings					
300D	. . . Gasket, Pan (Cork)	.1	.95-Up	.56300E	. . . E5TZ-7A191-A
300D	. . . Gasket, Pan (Fiber)	.1	.95-Up	.56300EF	. . . E5TZ-7A191-A
305H	. . . Gasket, Extension Housing	.1	.95-Up	.56305	. . . D4ZZ-7086-B
N.I.	. . . Gasket, Extension Adapter to 1356 Transfer Case	.1	.95-Up	.315304	
307D	. . . Gasket, Reverse Servo Cover	.1	.95-Up	.56307	. . . D4ZZ-7L173-A
310A	. . . Gasket, Pump	.1	.95-Up	.56310	. . . ZZLO-19-221
311A	. . . O-Ring, Front Pump	.1	.95-Up	.56311	. . . D5ZZ-7A248-A
312A	. . . O-Ring, Pump Bolt	.8	.95-Up	.56312	. . . E804595-S200
320D	. . . Gasket, Valve Body (Upper)	.1	.95-Up	.56320H	. . . F5TZ-7C155-A
321D	. . . Gasket, Valve Body (Lower)	.1	.95-Up	.56321H	. . . F5TZ-7D100-B
334C	. . . Lathe Cut Seal, Forward Clutch (Inner)	.1	.95-Up	.56334	. . . D5ZZ-7E062-A

Ford 4R44E/55E, 5R44E/55E

ILL #	Description	Qty	Year	Part #	Reference
Gaskets & O-Rings					
335CLathe Cut Seal, Forward Clutch (Outer)	.1	.95-Up	.56335D4ZZ-7A548-B
336ELip Seal, Overdrive Clutch (Inner)	.2	.95-Up	.56336AD7ZZ-7D404-A
337ELip Seal, Overdrive Clutch (Outer)	.2	.95-96	.56337AD7ZZ-7A548-A
337ELip Seal, Overdrive Clutch (Outer)	.1	.95-97	.56337BE8TZ-7A548-A
336ELip Seal, Direct Clutch (Inner)	.2	.95-Up	.56336AD7ZZ-7D404-A
337ELip Seal, Direct Clutch (Outer)	.1	.95-Up	.56337AAF0TZ-7A548-A
362DO-Ring, Intermediate & Overdrive Servo	.2	.95-Up	.56362AD4ZZ-7D040-A
363DO-Ring, Reverse Servo Seal (Small)	.1	.95-Up	.56363AE6TZ-7D040-A
363DO-Ring, Reverse Servo Seal (Large)	.1	.95-Up	.56363CD4ZZ-7423-B
371O-Ring, Filler Tube	.1	.95-Up	.44371A6264902
379O-Ring, Filter O-Ring (Small)	.1	.95-Up	.56379AE6TZ-7A469-B
379O-Ring, Filter O-Ring (Large)	.1	.95-Up	.56379LAE6TZ-7A469-A
381O-Ring, Inner Pump Gear to Converter Hub	.1	.95-Up	.56381	
Technical Manuals					
400HTech Manual, 4R44E, 4R55E (Electronic)	.1	.95-Up	.56400R83-4R44E,55E
400HTech Manual, 5R55E (5 Speed)	.1	.95-Up	.56400S83-5R55ETM
Electrical Components					
410DSwitch, Transmission Range Sensor (MLPS)	.1	.95-96	.76410EF5AZ-7A247-A
410DSwitch, Transmission Range Sensor (MLPS)	.1	.97-Up	.76410EAF7LZ-7F293-AB
420Solenoid Master Kit	.1	.95-96	.56420EK	
420Solenoid Master Kit	.1	.97-Up	.56420EAK	
421Solenoid, Shift/ Coast	.4	.97-Up	.56421BF7TZ-7G484-AB
425DSolenoid, TCC (w/o Inductive Signature)	.1	.95-96	.56425AF5TZ-7F037-AA
425DSolenoid, TCC (w/ Inductive Signature)	.1	.97-Up	.56425BXL2Z-7G136-AA
431Solenoid, EPC (2 Green Screens)	.1	.95-96	.56431F5TZ-7H144-A
431Solenoid, EPC (2 Red Screens) (Will Retro 95-96 if T56165H Is Installed **)	.1	.97-Up	.56431AXL2Z-7G383-AA
 ** This May Cause Codes on Some 95 Explorers w/ Early Computers				
436Sensor, Output Speed (VSS)	.1	.95-96	.86436AE9LZ-9E731-A
436Sensor, Output Speed (VSS) (on case)	.1	.97-Up	.56436HF7RZ-7H103-BA
436Sensor, Output Speed (VSS) (on differential)	.1	.97-Up	.36436BF85Z-7L373-AC
438Sensor, Input Speed (TSS)	.1	.95-96	.56438HF5TZ-7M101-A
438Sensor, Input Speed (TSS)	.1	.97-Up	.46438XW4Z-7M183-AA
444DCase Connector, w/ Internal Wire Harness (Fits All 6 Solenoid Type VB's)	.1	.95-Up	.56444HF5TZ-7Z409-B
445Repair Kit, External Wire Harness (13 Prong)	.1	.95-Up	.56445EBK	
Pumps					
Prefix Key: AR = Reman, D = Dealer, A = New Aftermarket, Q = Quality Inspected, U = Used				
520AStator, w/ Gears (6 Bolt Electronic)	.1	.95-Up	.56520DXL2Z-7A103-BA
520AStator, w/ Gears (Outer Caged Bearing Type) (w/ Pointed Tooth Gears) 5R55E	.1	.97-Up	.56520GXL2Z-7A103-AB
520AStator, w/ Gears (Outer Caged Bearing Type) (w/ Round Tooth Gears) 5R55E	.1	.97-Up	.56520GA	
530APump Gears, O-Ring Type	.1	.95-Up	.56530A	
530APump Gears, (w/ Rounded T) 5R55E	.1	.95-Up	.56530E	
544APlate, Pump (6 Bolt Electronic)	.1	.95-Up	.56544D1L5Z-7B472-AA
Drums					
Prefix Key: AR = Reman, D = Dealer, A = New Aftermarket, Q = Quality Inspected, U = Used				
550EOverdrive (3 Clutch)	.1	.95-Up	.56550BF0TZ-7L669-A
550EOverdrive (2 Clutch)	.1	.95-Up	.56550BA	
550EOverdrive (2 Clutch) 5R55E	.1	.97-Up	.56550CF7TZ-7L669-AD
550EDrum Kit, Overdrive (3 Clutch) (w/ Piston, Fri, Steels)	.1	.95-Up	.56550BK	
554CForward (4 Clutch) (w/ Bearings Between Rings) 5R55E	.1	.97-Up	.56554E	
554CForward (5 Clutch) (w/ Bearings Between Rings) 5R55E	.1	.97-Up	.56554EA	
554CForward (5 Clutch) (Uses A Bearing # 226)	.1	.95-Up	.56554C	
554CForward (5 Clutch) (Does Not Use Bearing # 226)	.1	.95-Up	.56554CA	
554CForward (6 Clutch) (Uses A Bearing # 226)	.1	.95-Up	.56554DF0TZ-7A360-B
554CForward (6 Clutch) (Does Not Use Bearing # 226)	.1	.95-Up	.56554DA	
554CForward (6 Clutch) (Collar Bearing Design)	.1	.97-02	.56554EBF87Z-7D044-AA
555FDirect (4 Clutch) (Drive Lugs are .150" Thick)	.1	.95-Up	.56555KF0TZ-7D044-B
555FDirect (4 Clutch) (Drive Lugs are .350" Thick)	.1	.95-Up	.56555KA	

Ford 4R44E/55E, 5R44E/55E

4R44E, 4R55E, 5R44E, 5R55E

Rwd 4/5 Speed

ILL #	Description	Qty	Year	Part #	Reference
Drums					
555F	. . .Direct (4 Clutch) (Drive Lugs are .350" Thick) 5R55E	.1	.97-Up	.56555N	
555F	. . .Direct (5 Clutch) (Drive Lugs are .150" Thick)	.1	.95-Up	.56555L	. . .F0TZ-7D044-C
555F	. . .Direct (5 Clutch) (Drive Lugs are .350" Thick)	.1	.95-Up	.56555LA	. . .F5TZ-7D044-D
555F	. . .Direct (5 Clutch) (Drive Lugs are .350" Thick) 5R55E	.1	.97-Up	.56555NA	
555F	. . .Direct (6 Clutch) (Drive Lugs are .150" Thick)	.1	.95-Up	.56555M	
555F	. . .Direct (6 Clutch) (Drive Lugs are .350" Thick)	.1	.95-Up	.56555MA	. . .F0TZ-7D044-C
555F	. . .Direct (6 Clutch) (Drive Lugs are .350" Thick) 5R55E	.1	.97-Up	.56555NB	
556D	. . .Reverse (Uses Roller Type Sprag) (10 Lugs on Drum) (Sold w/o Sprag)	.1	.95-Up	.56556	. . .D4ZZ-7C498-A
556D	. . .Reverse (w/ Lug Type Sprag) (30 Lugs on Drum) (4.0L)	.1	.95-Up	.56556A	. . .F0TZ-7C498-A
556D	. . .Reverse (w/ Lug Type Sprag) (10 Lugs on Drum) 5R55E	.1	.97-Up	.56556B	
560E	. . .Piston Kit, Overdrive Drum	.1	.95-Up	.56560A	
560E	. . .Piston Kit, Overdrive Drum 5R55E	.1	.97-Up	.56560C	
564C	. . .Piston Kit, Forward Drum	.1	.95-Up	.56564B	. . .D8ZZ-7A262-A
565F	. . .Piston Kit, Direct Drum	.1	.95-Up	.56565D	. . .F0TZ-7C054-A
Planets					
.Prefix Key: AR = Reman, D = Dealer, A = New Aftermarket, Q = Quality Inspected, U = Used					
580B	. . .Overdrive (w/ Tin Electric Pick-Up)	.1	.95-Up	.56580A	. . .XL2Z-7B446-AB
580B	. . .Overdrive (w/ Tin Electric Pick-Up) (w/ Lube Enhancements)	.1	.95-Up	.56580C	
582G	. . .Forward (3 Gear)	.1	.95-Up	.56582BB	
582G	. . .Forward (4 Gear) (Has a 1 Piece Bearing Inside)	.1	.95-Up	.56582DC	
582G	. . .Forward (4 Gear) (Has a 3 Piece Bearing Inside)	.1	.95-Up	.56582DB	
582G	. . .Forward (6 Gear)	.1	.95-Up	.56582EA	
582G	. . .Forward (6 Gear) (Uses a .350" Thick Brass Washer) (3 Piece Bearing Inside)	.1	.95-Up	.56582G	
582G	. . .Forward Planet Kit, (6 Gear) (Includes # 232, 602, 235, & 582)	.1	.95-Up	.56582EK	
584G	. . .Rear (3 Gear) Aluminum	.1	.95-Up	.56584	. . .E7SZ-7D006-C
584G	. . .Rear (3 Gear) Steel	.1	.95-Up	.56584B	
584G	. . .Rear (4 Gear)	.1	.95-Up	.56584D	. . .E7SZ-7D006-AA
584G	. . .Rear (6 Gear) (10 Driving Lugs) (Washer Type)	.1	.95-Up	.56584E	. . .E7SZ-7D006-AA
584G	. . .Rear (6 Gear) (10 Driving Lugs) (Bearing Type)	.1	.95-Up	.56584G	
584G	. . .Rear (6 Gear) (30 Driving Lugs)	.1	.95-Up	.56584EA	. . .F0TZ-7D006-A
590B	. . .Ring Gear, Overdrive Planet (Used w/ Plastic Caged Sprag)	.1	.95-Up	.56590B	. . .F3TZ-7A153-A
592G	. . .Ring Gear, Forward Planet	.1	.95-Up	.56592B	
594G	. . .Ring Gear, Rear Planet (Washer Type)	.1	.95-Up	.56594	. . .D4ZZ-7A153-A
602G	. . .Hub, Forward Ring Gear	.1	.95-Up	.56602C	
604G	. . .Hub, Rear Ring Gear (1.235" OD Nose)	.1	.95-Up	.56604A	
604G	. . .Hub, Rear Ring Gear (1.375" OD Nose) w/ Oil Dam	.1	.95-Up	.56604AB	
604G	. . .Hub, Rear Ring Gear (1.485" OD Nose) (.850" Overall Height)	.1	.95-Up	.56604AD	
604G	. . .Hub, Rear Ring Gear (1.590" OD Nose) (.733" Overall Height)	.1	.95-Up	.56604B	
604G	. . .Hub, Rear Ring Gear (1.590" OD Nose) (.855" Overall Height)	.1	.95-Up	.56604AC	
604G	. . .Hub, Rear Ring Gear (1.610" OD Nose) w/ Oil Dam (4.0L)	.1	.95-Up	.56604AA	. . .F87Z-7D164-AA
Sun Gears, Shells & Supports					
.Prefix Key: AR = Reman, D = Dealer, A = New Aftermarket, Q = Quality Inspected, U = Used					
610B	. . .Sun Gear, Overdrive	.1	.95-Up	.56610	. . .F7RZ-7D063-AA
612G	. . .Sun Gear, Forward (No Bushing Type)	.1	.95-Up	.56612A	. . .F0TZ-7D063-B
612G	. . .Sun Gear, Forward (2 Bushing Type)	.1	.95-Up	.56612	. . .D4ZZ-7D063-A
622G	. . .Shell, Driving 4R44E, 4R55E (Exc. 4.0L)	.1	.95-Up	.56622	. . .D4AA-7D064-A
622G	. . .Shell, Driving 4R44E, 4R55E (4.0L)	.1	.95-Up	.56622A	. . .F0TZ-7D064-A
622G	. . .Shell, Driving 5R44E, 5R55E	.1	.97-Up	.56622C	. . .F77Z-7D064-BB
622G	. . .Sun Gear & Shell, 4R44E, 4R55E (Exc 4.0L)	.1	.95-Up	.56622K	
622G	. . .Sun Gear & Shell, 4R44E, 4R55E (4.0L)	.1	.95-Up	.56622AK	
622G	. . .Sun Gear & Shell, 5R55E	.1	.97-Up	.56622CK	
630B	. . .Center Support, (Uses a Flat Bearing # 226)	.1	.95-Up	.56630B	. . .F5TZ-7A130-CC
630B	. . .Center Support, (Has a Caged Bearing In Ring Area)	.1	.97-Up	.56630C	. . .F77Z-7A130-CB
630B	. . .Sleeve, Center Support/ Overdrive Shaft (Sonnax)	.1	.95-Up	.56630-2	. . .56219-05K
N.I.	. . .Tool For S56630-2 (Sonnax)	.1	.95-Up	T-56219-06K	. . .56219-06K
Sprags					
650B	. . .Sprag, Overdrive (Cage - Plastic Top and Side) Narrow	.1	.95-96	.56650B	. . .92GT-7C109-AA
650B	. . .Sprag, Overdrive (Cage - Plastic Side/ Brass Top) Wide	.1	.97-Up	.56650H	. . .BWK 1310362

Ford 4R44E/55E, 5R44E/55E

ILL #	Description	Qty	Year	Part #	Reference
Sprags					
654D	.Sprag, Rear (Spring & Roller Kit) (Exc 4.0L)	.1	.95-Up	.56654	.D4ZZ-7D191-A
654D	.Sprag, Rear (Rollers)	.10	.95-Up	.56654-1	.D4ZZ-7D190-A
654D	.Sprag, Rear (Low) Clutch 26 Elements (4.0L)	.1	.95-96	.56654A	.90GT-7F109-BB
654D	.Sprag, Rear (Low) Clutch 16 Elements (Exc 4.0L) (Can Use 56654HA)	.1	.97-Up	.56654H	.97GT-7E193-CC
654D	.Sprag, Rear (Low) Clutch 26 Elements (4.0L) (Replaces 16 Element Sprag)	.1	.97-Up	.56654HA	.97GT-7E193-AD
664D	.Inner Race, Rear Sprag (Roller Sprag) (Presses In Case)	.1	.95-96	.56664A	
664D	.Inner Race, Rear Sprag (Lug Type Sprag) (4.0L)	.1	.95-96	.56664B	
664D	.Inner Race, Rear Sprag (Roller Sprag) (Presses In Case) (Sonnax)	.1	.95-96	.S56664A	.56600
664D	.Inner Race, Rear Sprag Late Model (Sonnax) (Uses T-56600-DJ)	.1	.95-96	.S56664B	.56600B
664D	.Sprag Update Kit (Sonnax) (Uses T-56600-DJ)	.1	.95-96	.S56664BK	.56600B-Q1K
N.I.	.Tool For S56664B & S56664BK (Sonnax)	.1	.95-96	.T-56600-DJ	.56600-DJ
Shafts					
.Prefix Key: AR = Reman, D = Dealer, A = New Aftermarket, Q = Quality Inspected, U = Used					
670A	.Input Shaft, (10" Long)	.1	.95-Up	.56670B	
674B	.Center Shaft, 4R44E, 4R55E w/ Neck (Exc. 4.0L)	.1	.95-96	.56674B	.F2TZ-7A658-B
674B	.Center Shaft, 4R44E, 4R55E (w/o Neck) (4.0L)	.1	.95-96	.56674A	.F2TZ-7A658-A
674B	.Center Shaft, 5R44E, 5R55E (Angled Shoulder) (4.0L)	.1	.97-Up	.56674C	.XL2Z-7A658-AA
678H	.Output Shaft, 2wd (Spd-O-Gear is 4 7/8" From End of Shaft) (No Bshng Sun Gr)	.1	.95-Up	.56678J	
678H	.Output Shaft, 2wd (Spd-O-Gear is 4 7/8" From End of Shaft) (2 Bshng Sun Gr)	.1	.95-Up	.56678E	
678H	.Output Shaft, 2wd (Spd-O-Gear is 6 1/2" From End of Shaft) (No Bshng Sun Gr)	.1	.95-Up	.56678JA	
678H	.Output Shaft, 2wd (Spd-O-Gear is 6 1/2" From End of Shaft) (2 Bshng Sun Gr)	.1	.95-Up	.56678EA	
678H	.Output Shaft, 2wd (Spd-O-Gear is 6 1/2" From End of Shaft) (2 Bshng Sun Gr)	.1	.95-Up	.56678G	
678H	.Output Shaft, 2wd (Spd-O-Gear is 6 1/2" From End of Shaft) (Bolt On Yoke)	.1	.95-Up	.56678GA	
678H	.Output Shaft, 4wd (Used w/ Sun Gear w/ No Bushings)	.1	.95-Up	.56678L	
678H	.Output Shaft, 4wd (Used w/ Sun Gear w/ 2 Bushings)	.1	.95-Up	.56678H	
Governors					
.Prefix Key: AR = Reman, D = Dealer, A = New Aftermarket, Q = Quality Inspected, U = Used					
685H	.Support, Parking Gear	.1	.95-Up	.56685C	
685H	.Support, Parking Gear 5R55E	.1	.95-Up	.56685D	
698G	.Oil Dam, 4.0L (Output Shaft Sleeve)	.1	.95-Up	.56698	.F0TZ-7B176-A
Valve Bodies					
.Prefix Key: AR = Reman, D = Dealer, A = New Aftermarket, Q = Quality Inspected, U = Used					
740D	.Valve Body (4R44E)	.1	.95-Up	.56740C	
740D	.Valve Body (4R55E)	.1	.95-Up	.56740C	
740D	.Valve Body (5R55E) (Output Speed Sensor in Case)	.1	.97-Up	.56740D	
741D	.Relief Valve, (Bag of 10) (Sonnax) 4R44E	.1	.95-Up	.S56741A-1	.10000-02K
741D	.Boost Valve Kit, w/ Sleeve (Sonnax) 4R44E, 4R55E, 5R55E	.1	.95-Up	.S56741F	.37947-01K
741D	.Boost Valve Kit, w/ Sleeve (Sonnax) 4R44E, 4R55E (Increased Ratio)	.1	.95-Up	.S56741FA	.37947-03K
741D	.End Plug Kit, Kickdown Control, Manual Low & Throttle Downshift (Sonnax)	.1	.95-Up	.S56741-6K	.37947-13K
741D	.Sleeve Kit, TCC Modulator Valve (Req T-37947-TL5)	.1	.95-Up	.S56741C-2K	.37947-07K
N.I.	.Reamer for S56741C-2K	.1	.95-Up	.T-37947-TL5	.37947-TL5
741D	.Sleeve Kit, Pressure Regulator Valve (Req T-37947-TL5)	.1	.95-Up	.S56741P-2K	.37947-05K
N.I.	.Reamer for S56741P-2K	.1	.95-Up	.T-37947-TL5	.37947-TL5
741D	.Sleeve Kit, TCC Regulator Valve (Req T-37947-TL9)	.1	.95-Up	.S56741Q-2K	.37947-09K
N.I.	.Reamer for S56741Q-2K	.1	.95-Up	.T-37947-TL9	.37947-TL9
741D	.Valve Kit, Coast Clutch (Oversized) (Sonnax) (Req T-37947-TL33)	.1	.95-Up	.S56741HK	.37947-33K
N.I.	.Reamer for S56741HK	.1	.95-Up	.T-37947-TL33	.37947-TL33
747D	.Plate, Valve Body Separator Plate	.1	.95-Up	.56747C	
747D	.Plate, Valve Body Separator Plate 4R55E	.1	.95-Up	.56747D	
Cases & Housings					
.Prefix Key: AR = Reman, D = Dealer, A = New Aftermarket, Q = Quality Inspected, U = Used					
750A	.Bell Housing, 2.3L (w/ 3 Bolt Starter) (2 Top Bolts - 5 1/8" Center to Center)	.1	.95-96	.56750G	
750A	.Bell Housing, 3.0L (w/ 3 Bolt Starter) (2 Top Bolts - 4 3/4" Center to Center)	.1	.95-96	.56750H	
750A	.Bell Housing, 4.0L (w/ 2 Bolt Starter) (2 Top Bolts - 3 3/8" Center to Center)	.1	.95-96	.56750J	
750A	.Bell Housing, 4.0L (w/ 2 Bolt Starter) (2 Top Bolts - 3 3/8" Center to Center)	.1	.97-Up	.56750JA	
760D	.Case, 2.3L & 3.0L (Roller Type Sprag)	.1	.95-Up	.56760G	
760D	.Case, 4.0L (Lug Type Sprag) (Electronic)	.1	.95-Up	.56760H	

Ford 4R44E/55E, 5R44E/55E

4R44E, 4R55E, 5R44E, 5R55E

Rwd 4/5 Speed

ILL #	Description	Qty	Year	Part #	Reference
Cases & Housings					
760D	. .Case, (w/ 1 Sensor on Case) 5R55E	.1	.97-Up	.56760MA	.E5TZ-7A377-BC
760D	. .Case, (w/ 2 Sensors on Case) 5R55E	.1	.95-96	.56760M	.F77Z-7005-DB
765D	. .Pan, 2wd	.1	.95-Up	.56765G	
765D	. .Pan, 4wd	.1	.95-Up	.56765H	
770H	. .Ext Housing, 2wd (Speed-O-Hole is 4 1/8" From Rear Seal - Both Sides)	.1	.95-Up	.56770BB	
770H	. .Ext Housing, 2wd (Speed-O-Hole is 4 1/8" From Rear Seal - Drivers Side Only)	.1	.95-Up	.56770BA	
770H	. .Ext Housing, 2wd (Speed-O-Hole is 5 3/4" From Rear Seal - Drivers Side)	.1	.95-Up	.56770B	.E5TZ-7A039-C
770H	. .Extension Housing, 4wd (Cast # 85GT)	.1	.95-Up	.56770C	.E5TZ-7A039-B
770H	. .Extension Housing, 4wd (Cast # 90GT)	.1	.95-Up	.56770CA	
Snap Rings					
861E	. .Holds Overdrive Clutches In Drum .054"	.1	.95-Up	.56861	.E860126S
861E	. .Holds Overdrive Clutches In Drum .068"	.1	.95-Up	.56861A	.E860127S
861E	. .Holds Overdrive Clutches In Drum .082"	.1	.95-Up	.56861B	.E860128S
861E	. .Holds Overdrive Clutches In Drum .096"	.1	.95-Up	.56861C	.E860129S
862E	. .Holds Overdrive Clutch Spring Retainer In Drum	.1	.95-Up	.56862	.E860125S
868B	. .Holds Overdrive Ring Gear to Hub	.1	.95-Up	.56868	
876C	. .Holds Forward Clutches In Drum .054"	.1	.95-Up	.56861	
877C	. .Holds Forward Clutch Spring Retainer In Drum	.1	.95-Up	.56877	
878F	. .Holds Direct Clutches In Drum .054"	.1	.95-Up	.56861	
879F	. .Holds Direct Clutch Spring Retainer In Drum	.1	.95-Up	.56879	
881C	. .Holds Hub to Front Planet	.1	.95-Up	.56881	.D4ZZ-7A480-A
882C	. .Holds Front Ring Gear to Hub	.1	.95-Up	.56882	
883B	. .Holds Center Support to Case	.1	.95-Up	.56883	
884G	. .Holds Sun Gear In Shell	.2	.95-Up	.56884	
889G	. .Holds Rear Hub to Rear Ring Gear	.1	.95-Up	.56889	
890G	. .Holds Rear Planet In Reverse Drum (Exc 4.0L)	.1	.95-Up	.56890	
893D	. .Holds Rear Sprag to Rev Band Drum (Exc 4.0L)	.1	.95-Up	.56893	
894G	. .Holds Rear Hub to Output Shaft .077"	.1	.95-Up	.56894A	
896D	. .Holds Intermediate & Overdrive Servo Cover In Case	1-2	.95-Up	.56896	
Miscellaneous Components					
901D	. .Spring, Intermediate & Overdrive Servo (Blue)	1-2	.95-Up	.56901AB	.E0BZ-7D028-A
901D	. .Spring, Intermediate & Overdrive Servo (Green)	1-2	.95-Up	.56901AC	.E3TZ-7D028-A
901D	. .Spring, Intermediate & Overdrive Servo (Orange)	1-2	.95-Up	.56901A	.D4ZZ-7D028-A
901D	. .Spring, Intermediate & Overdrive Servo (Yellow)	1-2	.95-Up	.56901AA	.F0TZ-7D028-A
902D	. .Piston, Interm & O.Drive Servo (1.625" ID Cover # FB) (Piston # 90GT-7E221-F1A)	1-2	.95-Up	.56902AA	.F0TZ-7D021-B
902D	. .Piston, Interm & O.Drive Servo (1.690" ID Cover # EB) (Piston # 90GT-7E221-E1A)	1-2	.95-Up	.56902AB	.F7ZZ-7D021-EA
902D	. .Piston, Interm & O.Drive Servo (1.750" ID Cover # DB) (Piston # 90GT-7E221-D1A)	1-2	.95-Up	.56902AC	.F0TZ-7D021-A
902D	. .Piston, Interm & O.Drive Servo (1.812" ID Cover # CA/CB)	1-2	.95-Up	.56902AD	.E3ZZ-7D021-A
902D	. .Piston, Interm & O.Drive Servo (1.920" ID Cover # BA/BB) (Piston # 83DT-7E221-B1A)	1-2	.95-Up	.56902AE	.F2ZZ-7D021-A
902D	. .Piston, Interm & O.Drive Servo (2.075" ID Cover # AA/AB) (78DT/83DT-7E221-A1A/A2A)	1-2	.95-Up	.56902AG	.D4ZZ-7D021-A
902D	. .Piston, Interm & O.Drive Servo (2.317" ID Cover # ZC) (Piston Cast # 97GT-7E221-ZA)	1-2	.97-Up	.56902AJ	.F77Z-7D021-ZA
904D	. .Servo Cover, Intermediate & Overdrive (1.625" ID of Cover # FB)	1-2	.95-Up	.56904AA	
904D	. .Servo Cover, Intermediate & Overdrive (1.690" ID of Cover # EB)	1-2	.95-Up	.56904AB	
904D	. .Servo Cover, Intermediate & Overdrive (1.750" ID of Cover # DB)	1-2	.95-Up	.56904AC	
904D	. .Servo Cover, Intermediate & Overdrive (1.812" ID of Cover # CA/CB)	1-2	.95-Up	.56904AD	
904D	. .Servo Cover, Intermediate & Overdrive (1.920" ID of Cover # BA/BB)	1-2	.95-Up	.56904AE	
904D	. .Servo Cover, Intermediate & Overdrive (2.075" ID of Cover # AA/AB)	1-2	.95-Up	.56904AG	.2L5Z-7D027AA
904D	. .Servo Cover, Intermediate & Overdrive (2.317" ID of Cover # ZC)	1-2	.95-Up	.56904AJ	.F77Z-7D027-ZC
910D	. .Servo Assembly, Reverse (No Groove)	.1	.95-Up	.56910B	.XL2Z-7D189-BA
910D	. .Servo Assembly, Reverse (1 Groove)	.1	.95-Up	.56910	.D7ZZ-7D189-C
910D	. .Servo Assembly, Reverse (2 Groove)	.1	.95-Up	.56910A	.D7ZZ-7D189-A
911D	. .Spring, Reverse Servo	.1	.95-Up	.56911	.D4ZZ-7D031-A
912D	. .Piston, Reverse Servo	.1	.95-Up	.56912	
913	. .Reverse Servo Extendo Pin	.1	.95-Up	.56913A	
914D	. .Cover, Reverse Servo	.1	.95-Up	.56914	
915H	. .Band Strut Set, Overdrive Band (Band Lever Cast # A)	.1	.95-Up	.56915	
915H	. .Band Strut Set, Overdrive Band (Band Lever Cast # C)	.1	.95-Up	.56915A	
915H	. .Band Strut Set, Overdrive Band (Band Lever Cast # D)	.1	.95-Up	.56915B	
915H	. .Band Strut Set, Overdrive Band (Band Lever Cast # E)	.1	.95-Up	.56915C	

Ford 4R44E/55E, 5R44E/55E

ILL #	Description	Qty	Year	Part #	Reference
Miscellaneous Components					
915H	.Band Strut Set, Overdrive Band (Band Lever Cast # G)	.1	.95-Up	.56915D	
916H	.Band Strut Set, Intermediate Band (Band Lever Cast # A)	.1	.95-Up	.56916	.D4ZZ-7D029-A
916H	.Band Strut Set, Intermediate Band (Band Lever Cast # C)	.1	.95-Up	.56916A	
916H	.Band Strut Set, Intermediate Band (Band Lever Cast # D)	.1	.95-Up	.56916B	
916H	.Band Strut Set, Intermediate Band (Band Lever Cast # E)	.1	.95-Up	.56916C	
916H	.Band Strut Set, Intermediate Band (Band Lever Cast # G)	.1	.95-Up	.56916D	
922H	.Nut, Band Adjustment Nut (Coarse Threads)	.1-2	.95-Up	.26922	.380850-S
961E	.Piston, Overdrive & Direct Clutch (Steel Drums)	.1-2	.95-Up	.56961	.E8TZ-7A262-A
964C	.Piston, Forward Clutch	.1	.95-Up	.56964	
965	.Piston, Direct Clutch (Cast Iron Drums)	.1	.95-Up	.56965	.FOTZ-7A262-B
971E	.Springs, Overdrive & Direct Drum Return	.20	.95-Up	.56971	.F1TZ-7A480-B
981E	.Retainer, Overdrive Drum Spring	.1	.95-Up	.56981	.ESTZ-7A527-A
984C	.Retainer, Forward Clutch Spring	.1	.95-Up	.56984	
985F	.Retainer, Direct Clutch Spring	.1	.95-Up	.56985	
991H	.Linkage, Internal w/ Park Rod	.1	.95-Up	.56991A	
992D	.Lever, Manual Linkage	.1	.95-Up	.56992BA	
995H	.Park Pawl Assembly	.1	.95-Up	.56995	
N.I.	.Flywheel Spacer, 8 Bolt	.1	.85-94	.AF235SA	
Sonnax					
741D	.Relief Valve, (Bag of 10) 4R44E	.1	.95-Up	.S56741A-1	.10000-02K
741D	.Boost Valve Kit, w/ Sleeve 4R44E, 4R55E, 5R55E	.1	.95-Up	.S56741F	.37947-01K
741D	.Boost Valve Kit, w/ Sleeve (Sonnax) 4R44E, 4R55E (Increased Ratio)	.1	.95-Up	.S56741FA	.37947-03K
741D	.Sleeve Kit, Pressure Regulator Valve (Req T-37947-TL5)	.1	.95-Up	.S56741P-2K	.37947-05K
741D	.Sleeve Kit, TCC Modulator Valve (Req T-37947-TL5)	.1	.95-Up	.S56741C-2K	.37947-07K
741D	.Sleeve Kit, TCC Regulator Valve (Req T-37947-TL9)	.1	.95-Up	.S56741Q-2K	.37947-09K
741D	.End Plug Kit, Kickdown Control, Manual Low & Throttle Downshift (Sonnax)	.1	.95-Up	.S56741-6K	.37947-13K
741D	.Valve Kit, Coast Clutch (Oversized) (Sonnax) (Req T-37947-TL33)	.1	.95-Up	.S56741HK	.37947-33K
165H	.Valve Body Kit (Sonnax EZ)	.1	.95-Up	.A56165H	.37947-EZ
N.I.	.Reamer for S56741C-2K & S56741P-2K	.1	.95-Up	.T-37947-TL5	.37947-TL5
N.I.	.Reamer for S56741Q-2K	.1	.95-Up	.T-37947-TL9	.37947-TL9
N.I.	.Reamer for S56741HK	.1	.95-Up	.T-37947-TL33	.37947-TL33
034A	.Converter Housing (Unfinished)	.1	.95-Up	.S56034	.56001X
630B	.Sleeve, Center Support/ Overdrive Shaft	.1	.95-Up	.S56630-2	.56219-05K
N.I.	.Tool For S56630-2	.1	.95-Up	.T-56219-06K	.56219-06K
257D	.Washer Kit, Low Sprag End Cap & Washer	.1	.95-Up	.S56257K	.56250-01K
664D	.Inner Race, Rear Sprag (Roller Sprag) (Presses In Case)	.1	.95-96	.S56664A	.56600
664D	.Inner Race, Rear Sprag Late Model (Uses T-56600-DJ)	.1	.95-96	.S56664B	.56600B
664D	.Sprag Update Kit (Uses T-56600-DJ)	.1	.95-96	.S56664BK	.56600B-01K
N.I.	.Tool For S56664B & S56664BK	.1	.95-96	.T-56600-DJ	.56600-DJ

Ford 4R44E/55E, 5R44E/55E